

- Notes:
1. PF30A uses 6806 (61806) bearings in delrin cups
 2. Nominal 6806 bearing fit into cup is p6/M7
 3. Bearing size conforms to ISO/DIN/JIS
 4. Use of retaining compound in an aluminium shell is recommended
 5. Use of retainig compound and activator/primer is recommended in a carbon shell
 6. Designed for 30mm Axle

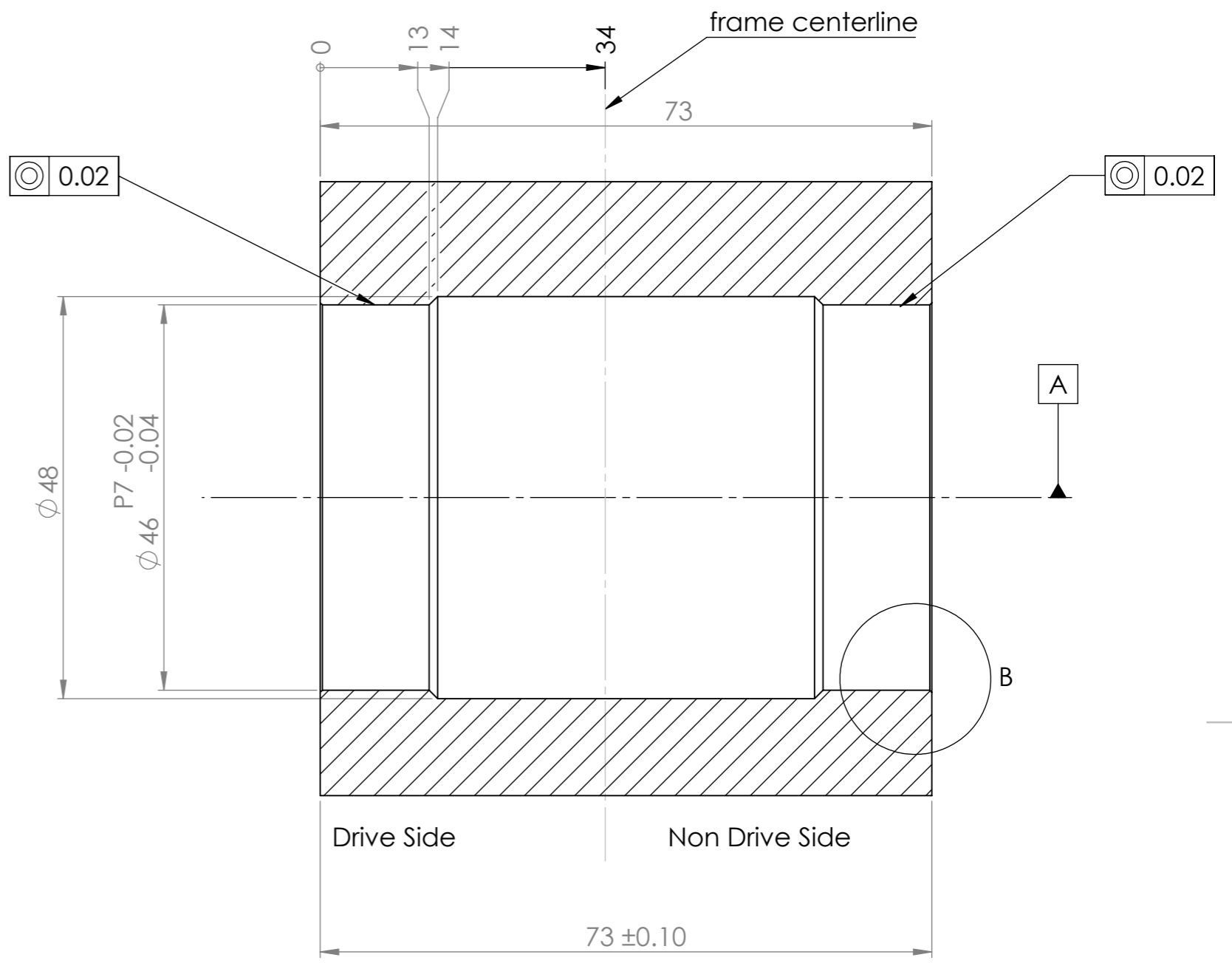

UNLESS OTHERWISE SPECIFIED: DIMENSIONS ARE IN MILLIMETERS SURFACE FINISH: 3.2 TOLERANCES: LINEAR: +/- 0.05mm ANGULAR: +/- 0.05deg		FINISH: Ra 1.6	DEBURR AND BREAK SHARP EDGES	DO NOT SCALE DRAWING	REVISION
DRAWN			www.hambini.com		
CHK'D			hambini performance engineering		
APPV'D			DWG NO. PF30A Shell		
MFG			A3		
Q.A			SCALE:1.5:1		
MATERIAL: n/a			SHEET 1 OF 1		
WEIGHT:					